

# **Ryan Trecartin**

# **Re'Search Wait'S**

**Artwork labels**

# Map

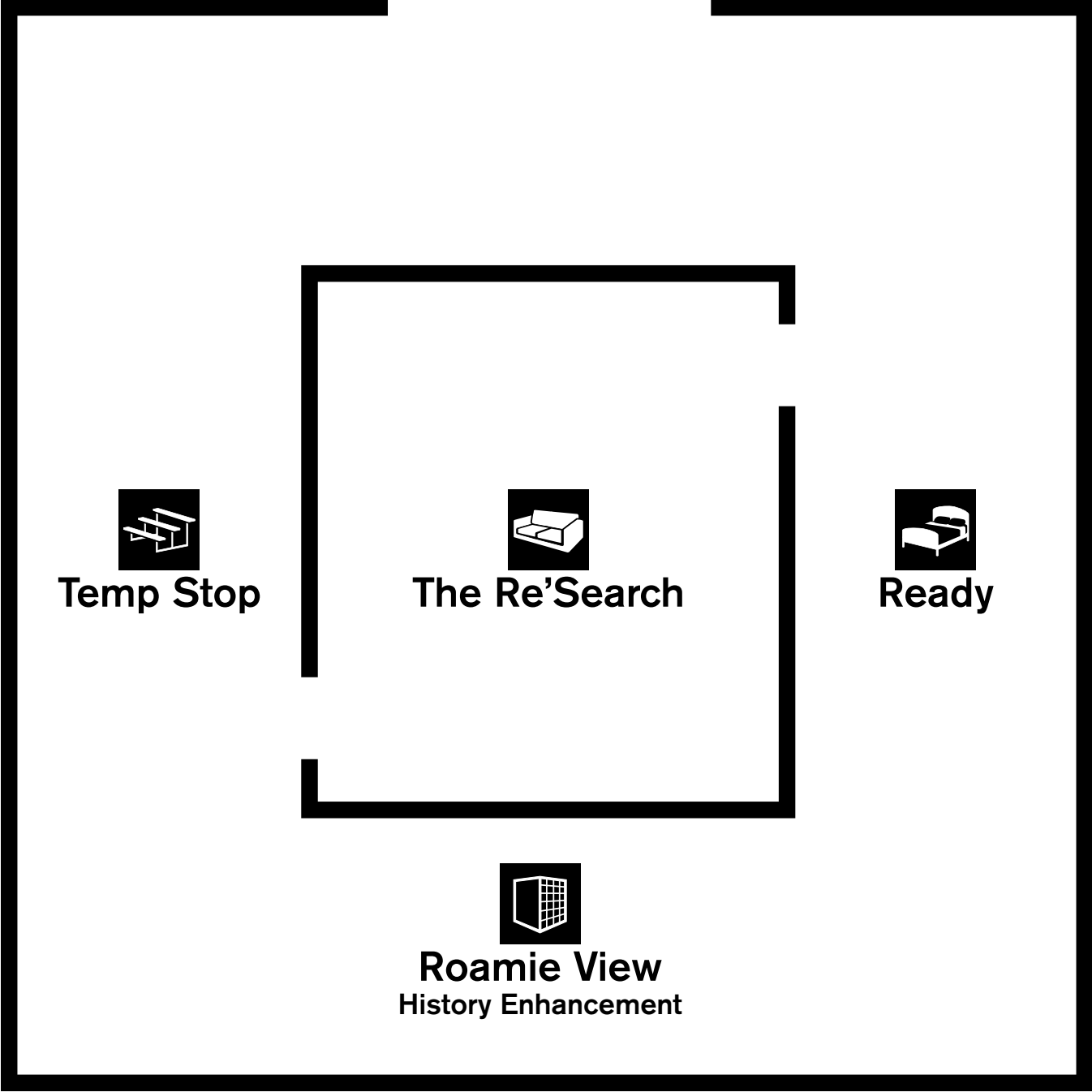



## Ready

In *Ready* the character Wait, played by Trecartin, is introduced as the eponymous figure of the series. He forsakes a career in favour of a job, the execution of which Trecartin calls a 'work performance'. Wait is joined by a careerist, Y-Ready (Veronica Gelbaum), who calls the shots but is locked in her own endless narcissistic ascent. A third type of worker, Able (Lizzie Fitch), more fluidly adopts and discards the gestures of job and career, posing herself as a hobbyist who contrives the situations and outcomes she needs to keep going. The idea of 'transumerism', or consumerism driven by experience, is also introduced as a central theme and underlies the plight of the character JJ (Trecartin).

# **Ryan TRECARTIN**

American 1981–

## **Ready (Re'Search Wait'S)**

2009–10

single channel colour digital video and stereo sound,  
26 min, 50 sec

Collection of the artist

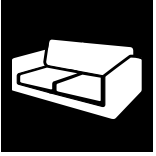

## The Re'Search

*The Re'Search* is a 'tweenaged' microcosm of the *Any Ever* series. Functioning as market research collected by the character Wait for the character Y-Ready, the movie doubles as the site of Wait's vacation. Echoed versions of scenarios from the other movies play out here, and characters either reappear or are replicated as young girls. It is also a production commissioned for the character Voy (Ella Weisskamp), who moves in and out of the action while blurring the boundaries of what is inside and outside reality and fiction.

## **Lizzie FITCH**

American 1981–

## **Ryan TRECARTIN**

American 1981–

## **Available Sync**

2011

sofas, armchairs, chaise longue, footrests, nightstands, chests of drawers, sideboard, dresser, cabinet, TV units, printed canvases, clothes racks and hooks, cat houses, saw horses, mitre-saw stand, vice stand, work bench, tool box, axe, pick-axe, crowbar, hammers, crushing pick, ice-pick handle, wrenches, files, saw blades, hex keys, zip ties, T-square, clothing, purses, vases, cushions, mirrors, lighting gels

## **The Re'Search (Re'Search Wait'S)**

2009–10

single channel colour digital video and stereo sound,  
40 min, 6 sec

Loti & Victor Smorgon Fund, 2015

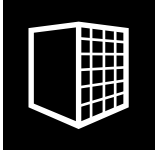

## **Roamie View** **History Enhancement**

*Roamie View : History Enhancement* reveals the character JJ as a husk of his former self. In the movie he hires Roamie Hood's (Alison Powell) company to roam backwards through time to research an opportunity for an edit that could alter his future-present. With Backseat Grace (Rachel Lord) and Liberty Lance (Liz Rywelski), Roamie enters the suburban lair of three average teenage boys, and then an animated environment strewn with stock footage videos of female assistants in both corporate and shopping settings. Traversing times and possibilities as if they were physical places, *Roamie View : History Enhancement* foregoes the importance of grasping who one is in favour of where one is.

**Ryan TRECARTIN**

American 1981–

**Roamie View: History Enhancement  
(Re'Search Wait'S)**

2009–10

single channel colour digital video and stereo sound,  
28 min, 24 sec

Collection of the artist





## Temp Stop

*Temp Stop*, as the title implies, has a disjunctive quality that separates it from the other parts of *Re'Search Wait'S*. As if emanating from the basement of *Any Ever*, each scene plays like a hidden epilogue in which the characters appear surreal – in part because they are often so ordinary.

# **Ryan TRECARTIN**

American 1981–

## **Temp Stop (Re'Search Wait'S)**

2009–10

single channel colour digital video and stereo sound,  
11 min, 47 sec

Collection of the artist