

YAYOI KUSAMA

GROUND LEVEL, NGV INTERNATIONAL



This is a suggested route and key moments for school groups visiting Yayoi Kusama at the NGV. It includes opportunities to view and explore Kusama's paintings, drawings, sculptures and more. You'll find more information about the immersive and infinity rooms numbered 1-4 on this map on the next page.



Dots Obsession

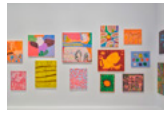

Every Day I Pray for Love series



Dots Obsession

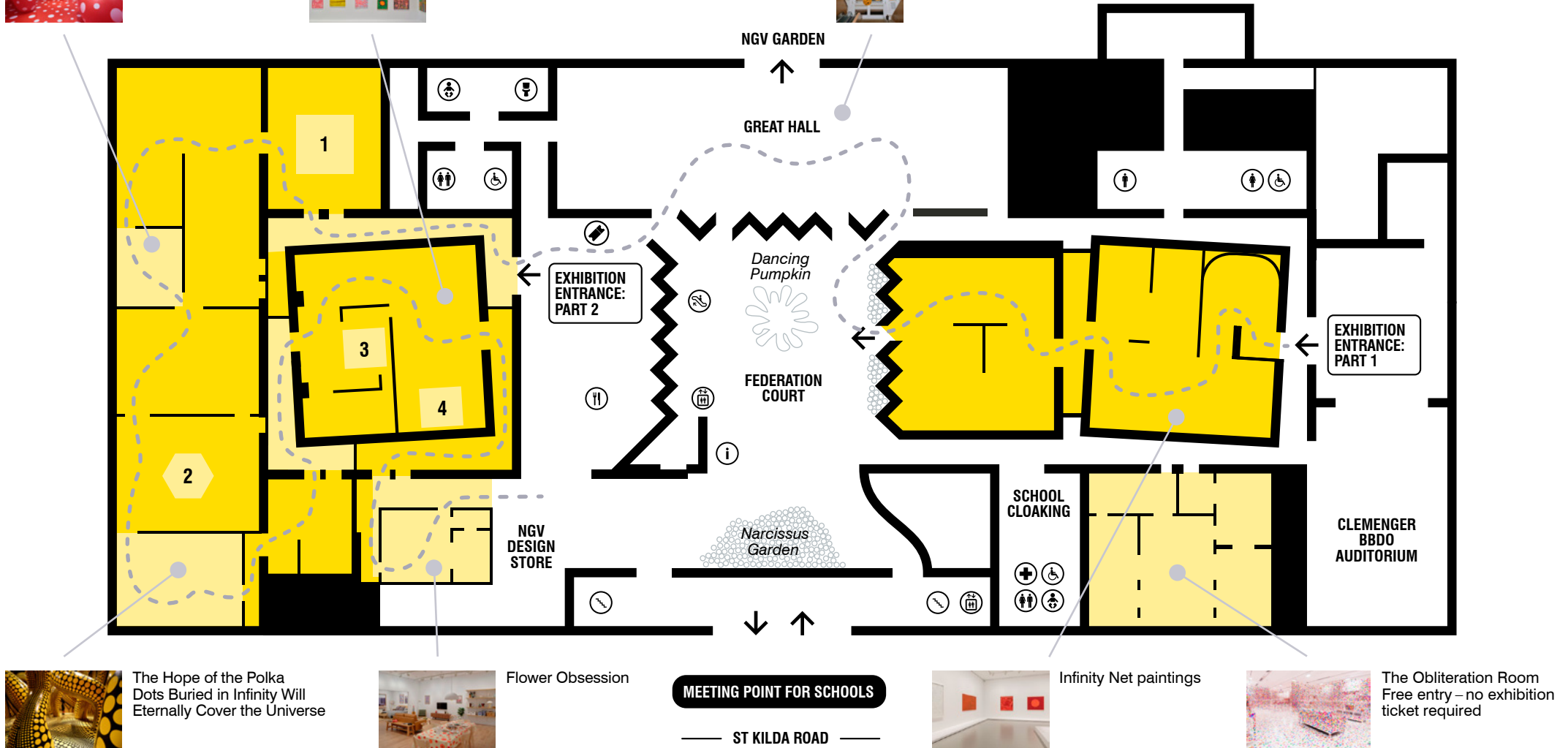

The Hope of the Polka Dots Buried in Infinity Will Eternally Cover the Universe



Flower Obsession

MEETING POINT FOR SCHOOLS

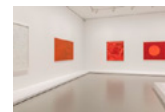

Infinity Net paintings

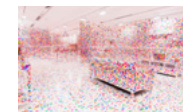

The Obliteration Room
Free entry – no exhibition ticket required

ST KILDA ROAD

Public area, no ticket required
 Exhibition ticket required
 Immeration space
 Suggested route for school groups

OPTIONAL INFINITY & IMMERSIVE ROOM EXPERIENCES IN THE EXHIBITION



If you have more time, you might like to experience one or more of Kusama's infinity or immersive room installations while visiting the exhibition with your students. Capacity in the four spaces described below is limited, and visitors (including school groups) may be asked to join a queue before entering these spaces. Please take into account the time available to explore the exhibition. Adult supervision of student groups is required in all infinity and immersive spaces.

1. The Spirits of the Pumpkins Descended into the Heavens

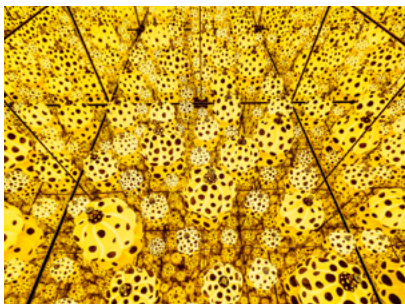

Description: This immersive room features a mirrored cube with a small open window. It is wheelchair accessible, however, a small step is required to view inside the cube. A tablet is available to show the inside of the cube to those who are unable to see it.

Queueing: This experience is likely to have significant queues and wait times.

Capacity: Only one student can access the step and view inside the cube at a time, unless assistance of an adult is required.

2. Chandelier of Grief



Description: This is an enclosed infinity room with mirrored walls and flickering lights.

Capacity: Eight people, including at least one adult, are allowed to enter the room at once.

Other considerations: Visitors enter and exit through the same door, which is closed while visitors experience the reflections inside. Adult supervision of student groups in this space is required. Visitors cannot touch the mirrors in this space.

3. Love is Calling



Description: This is an enclosed infinity room with mirrored walls, floor and ceiling. Colourful glowing tentacle-like forms extend from the floor and ceiling.

Capacity: Eight people, including at least one adult, are allowed to enter the room at once.

Other considerations: Visitors enter through one door and will exit via another. The entrance and exit doors will be closed while visitors experience the reflections inside. Adult supervision of student groups in this space is required. Visitors cannot touch the mirrors nor the objects in this space.

4. Infinity Mirrored Room – My Heart is Filled to the Brim with Sparkling Light



Description: This is an enclosed infinity room with mirrored walls, floor and ceiling. The space is quite dark and several mirrored domes are installed in the room. The domes feature small colourful lights.

Capacity: Ten people, including at least one adult, are allowed to enter the room at once.

Other considerations: Visitors enter through one door and will exit via another. The entrance and exit doors will be closed while visitors experience the reflections inside. Adult supervision of student groups in this space is required. Visitors cannot touch the mirrors nor the objects in this space.

NGV SCHOOLS PROGRAM PARTNERS



The NGV warmly thanks Krystyna Campbell-Pretty AM and Family for their support of the NGV School Support Program.

